

**SMART/RG®**  
forward thinking



## Quick Start Guide

### MC20

This Quick Start Guide shows you how to set up and begin using your new adapter.

# INSTALLATION

The MC20 adapter is installed between the incoming coaxial wall jack and the destination device, such as a TV or a set-top box.

- ① Connect a coax cable to the cable wall jack and to the **MoCA® IN** port on the adapter.
- ② Connect an Ethernet cable to your set-top box and to the **Ethernet** port of the adapter.
- ③ Connect the power adapter to a wall outlet and then to the **DC 5V** port on the adapter. Press the **ON/OFF** button.

If you cannot access your services, verify all cables are securely connected.

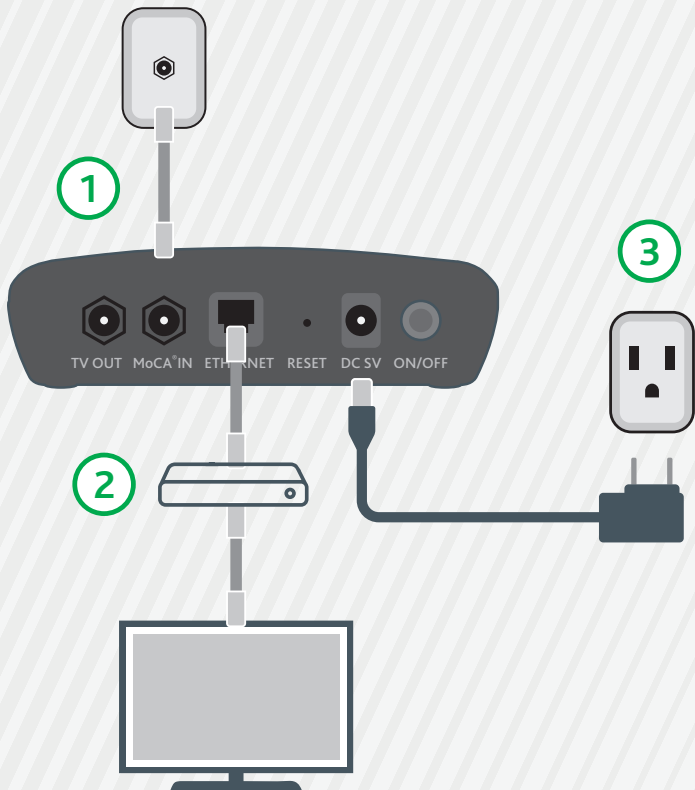





# LED INDICATORS

The LEDs on the top of the MC20 can help you understand the current state of your adapter.



**Legend:**  Green  Green blinking  White  White blinking

LED	Action	Explanation
Power		Adapter has power
Ethernet		Ethernet is connected
		Data being transmitted
MoCA <sup>®</sup>		MoCA is available
		Data being transmitted

# OPTIONAL WALL MOUNT

- 1 Insert the two included screws into the wall using the template below. Using wall anchors is recommended.

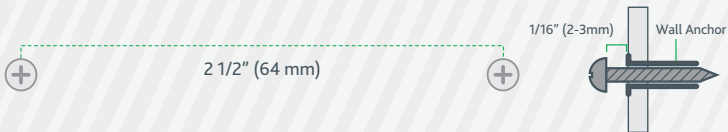

- 2 Slide the adapter down on the screws.

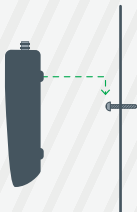

# ADDITIONAL SUPPORT

If you require further instructions, please contact your local ISP Support.