

SMART/RG

An ADTRAN Company

SR501

Quick Start Guide



Installation

- ① Connect the supplied DSL cable to the DSL port on your gateway and to the DSL wall jack installed by your provider.
- ② Connect an Ethernet cable from your device (e.g., laptop) to the **ETH** port on the gateway.
- ③ Plug the power cord into the wall outlet and into the **Power** jack on the back of the gateway.
- ④ Turn on the gateway by pressing the power switch on the back.

Your gateway is now being set up to connect to the Internet. It may take a few minutes before you can begin using your Internet applications (email, browser, etc.). If you are unable to connect to the Internet, verify that all connections are in place and that the gateway's power is turned on.

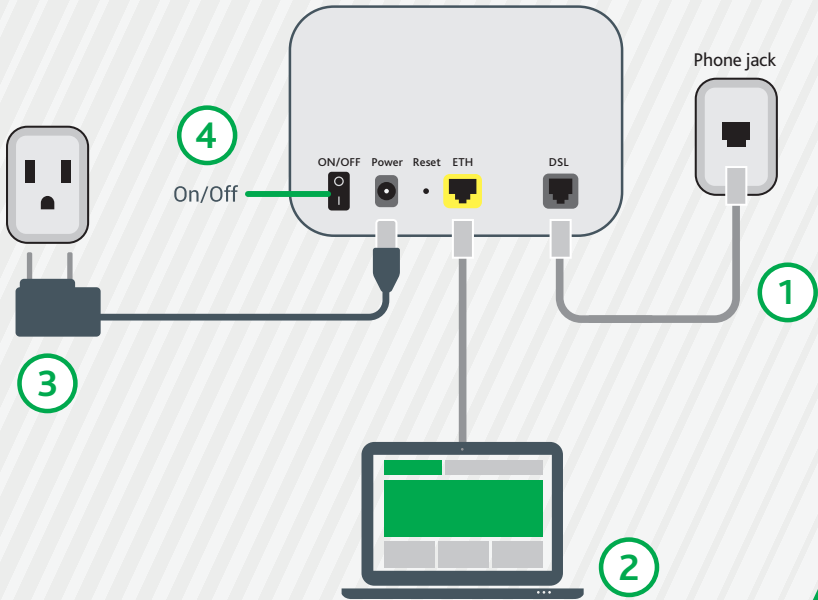

LED Indicators

The LEDs on the front of the SR501 can help you understand the current state of your gateway.

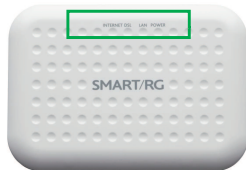

LED	Action	Meaning
INTERNET	●	Connected to Internet
	●	Authentication failed
DSL	⚙️	Connecting to DSL
	●	Connected to DSL
	⚙️	Transferring data
LAN	●	Connected to LAN
	⚙️	Transferring data
POWER	●	Unit is on

Logging in to your gateway

To change the settings on your gateway, you must log in to its interface. Make sure you have completed the ["Installation"](#) steps before you begin.

- 1 Open your internet browser application and type 192.168.1.1 into the address line. The login page appears.

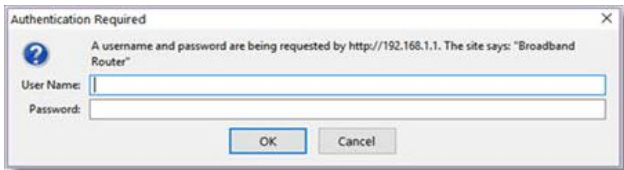

- 2 Enter the default username and password: admin/admin, and click **OK**. The Device Info summary page appears.

Note: Your service provider may use other settings. Please contact your provider for login information.

Configuring the WAN Manually

If the automatic connection process is unsuccessful, refer to the Advanced Setup > Layer 2 Interface and WAN Services sections of the SR501 Gateway User Manual to manually establish a connection.

Optional Wall Mount

- ① Using the template below, mount the two included screws to the wall. Using wall anchors is recommended.

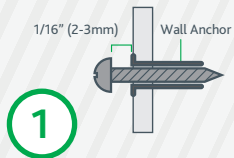
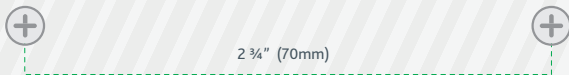

- ② Slide the back of the mount down on the screws.

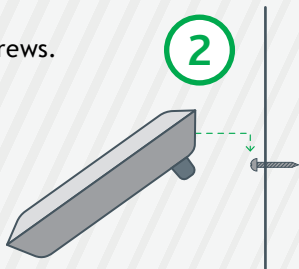

Additional Support

If you require further instructions, please contact your local ISP support.